

Reference: 2010/02434/01SPRN

Hearing: 27th January 2011

Application for Premises Licence

Premises Name: Liquid
 Premises Address: 69 Bedford Place
 Southampton
 Hampshire
 SO15 2DS

Application Date: 9th December 2010
 Application Received Date: 10th December 2010

Application Valid Date: 10th December 2010



This map is reproduced from Ordnance Survey material with the permission of Ordnance Survey on behalf of the Controller of Her Majesty's Stationery Office © Crown copyright. Unauthorised reproduction infringes Crown copyright and may lead to prosecution or civil proceedings. Southampton City Council Licence No. 100019679 2007.

Representation From Responsible Authorities

Responsible Authority	Satisfactory?	Comments
Child Protection Services - Licensing	No response received	
Hampshire Fire And Rescue - Licensing	No response received	
Environmental Health - Licensing	Yes	No objection
Planning & Sustainability - Building Control - Licensing	No response received	
Planning & Sustainability - Development Control - Licensing	No response received	
Hampshire Constabulary - Licensing	Yes	No objection, conditions agreed
Trading Standards - Licensing	Yes	No objection

Other Representations

Name	Address	Contributor Type
Mr. Simon Beer	Bridge Gallery 32 Bedford Place Southampton SO15 2DG	Trader
Ms. Susan Ridley	Banister Guest House 11 Brighton Road Southampton SO15 2JJ	Trader
Mr. Peter M. Nugent	Atlantic Dry Cleaners & Tailors 49/50 Bedford Place Southampton SO15 2DG	Trader
Dr. J. Krir	Avenue Clinic 76 Bedford Place Southampton SO15 2DF	Trader
Cllr P. Damani	Civic Centre Southampton SO14 7LY	Ward Councillor
Sam Lowe	Phase 3 Southampton 37 Bedford Place Southampton SO15 2DG	Trader
Ms. Marie-Claire Prettyman	81 Bedford Place Lower Ground Floor Bedford Place SO15 2DF	Trader
Ms. Karen Holloway	Esthetix Face & Body Care 31 Carlton Place Southampton SO15 2DX	Trader
Mr. Stuart Conway	Electric Bike World 54 Bedford Place Southampton SO15 2DT	Trader
Mr. Gerry Heeley	Phase 3 HiFi 37 Bedford Place Southampton SO15 2DG	Trader
Ms. Sue Conchie	Banister House 11 Brighton Road Southampton SO15 2JJ	Resident

Legal Implications

1. The Licensing Act 2003 specifically restricts the grounds on which the Council, as Licensing Authority (LA), may refuse an application for a new Premises Licence, or impose conditions. Where relevant representations are made, the LA may refuse on the grounds that the licensing objectives are not met or the operating schedule is inadequate. Equally, conditions may be imposed where relevant and necessary. The LA may also refuse an application in part and thereby only permit some of the licensable activities sought.
2. The decision making committee, in considering an application, must have regard to the adopted Statement of Licensing Policy and any relevant representations made by those directly affected.
3. An applicant for a new Premises Licence whose application has been refused, or who is aggrieved by conditions imposed, may appeal against the decision to the Magistrates' Court.
4. In considering this application the committee will sit in a quasi-judicial capacity and is thus obliged to consider applications in accordance with both the Licensing Act 2003 (Hearings) Regulations 2005, and amending secondary legislation and the rules of natural justice. The practical effect of this is that the committee must make its decision based on evidence submitted in accordance with the legislation and give adequate reasons for reaching its decision.

The committee must also have regard to:-

5. *Crime and Disorder Act 1998*
Section 17 of the Crime and Disorder Act 1998 places the Council under a duty to exercise its various functions with due regard to the likely effect of the exercise of those functions on, and the need to do all that it reasonably can to prevent, crime and disorder in its area.
6. *Human Rights Act 1998*
The Act requires UK legislation to be interpreted in a manner consistent with the European Convention on Human Rights. It is unlawful for the Council to act in a way that is incompatible (or fail to act in a way that is compatible) with the rights protected by the Act. Any action undertaken by the Council that could have an effect upon another person's Human Rights must be taken having regard to the principle of Proportionality - the need to balance the rights of the individual with the rights of the community as a whole. Any action taken by the Council which affects another's rights must be no more onerous than is necessary in a democratic society. The matter set out in this report must be considered in light of the above obligations.

Southampton City Council

Application for a premises licence to be granted under the Licensing Act 2003

PLEASE READ THE FOLLOWING INSTRUCTIONS FIRST

Before completing this form please read the guidance notes at the end of the form.
If you are completing this form by hand please write legibly in block capitals. In all cases ensure that your answers are inside the boxes and written in black ink. Use additional sheets if necessary.

You may wish to keep a copy of the completed form for your records.

I/We Zen Mobility LLP

(Insert name(s) of applicant)

apply for a premises licence under section 17 of the Licensing Act 2003 for the premises described in Part 1 below (the premises) and I/we are making this application to you as the relevant licensing authority in accordance with section 12 of the Licensing Act 2003

Part 1 – Premises Details

Postal address of premises or, if none, ordnance survey map reference or description 69 Bedford Place			
Post town	Southampton	Post code	SO15 2DS

Telephone number at premises (if any)	
Non-domestic rateable value of premises	£15,000

Part 2 - Applicant Details

Please state whether you are applying for a premises licence as
Please tick yes

- | | | |
|---|-------------------------------------|-----------------------------|
| a) an individual or individuals * | <input type="checkbox"/> | please complete section (A) |
| b) a person other than an individual * | | |
| i. as a limited company | <input type="checkbox"/> | please complete section (B) |
| ii. as a partnership | <input checked="" type="checkbox"/> | please complete section (B) |
| iii. as an unincorporated association or | <input type="checkbox"/> | please complete section (B) |
| iv. other (for example a statutory corporation) | <input type="checkbox"/> | please complete section (B) |
| c) a recognised club | <input type="checkbox"/> | please complete section (B) |

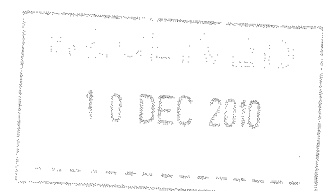

- d) a charity please complete section (B)
- e) the proprietor of an educational establishment please complete section (B)
- f) a health service body please complete section (B)
- g) a person who is registered under Part 2 of the Care Standards Act 2000 (c14) in respect of an independent hospital please complete section (B)
- h) the chief officer of police of a police force in England and Wales please complete section (B)

* If you are applying as a person described in (a) or (b) please confirm:

Please tick yes

- I am carrying on or proposing to carry on a business which involves the use of the premises for licensable activities; or
- I am making the application pursuant to a
 - statutory function or
 - a function discharged by virtue of Her Majesty's prerogative

(A) INDIVIDUAL APPLICANTS (fill in as applicable)

Mr <input type="checkbox"/>	Mrs <input type="checkbox"/>	Miss <input type="checkbox"/>	Ms <input type="checkbox"/>	Other Title (for example, Rev)	
Surname			First names		
I am 18 years old or over					<input type="checkbox"/> Please tick yes
Current postal address if different from premises address					
Post Town				Postcode	
Daytime contact telephone number					
E-mail address (optional)					

SECOND INDIVIDUAL APPLICANT (if applicable)

Mr <input type="checkbox"/>	Mrs <input type="checkbox"/>	Miss <input type="checkbox"/>	Ms <input type="checkbox"/>	Other Title (for example, Rev)	
Surname			First names		
I am 18 years old or over					<input type="checkbox"/> Please tick yes

Current postal address if different from premises address			
Post Town		Postcode	
Daytime contact telephone number			
E-mail address (optional)			

(B) OTHER APPLICANTS

Please provide name and registered address of applicant in full. Where appropriate please give any registered number. In the case of a partnership or other joint venture (other than a body corporate), please give the name and address of each party concerned.

Name Zen Mobility LLP	
Address 115 Portswood Road Portswood Southampton SO17 2FX	
Registered number (where applicable) OC357335	
Description of applicant (for example, partnership, company, unincorporated association etc.) Partnership	

Part 3 Operating Schedule

When do you want the premises licence to start?

Day Month Year

A	S	A	P				
---	---	---	---	--	--	--	--

If you wish the licence to be valid only for a limited period, when do you want it to end?

Day Month Year

--	--	--	--	--	--	--	--

Please give a general description of the premises (please read guidance note1)
Up-market off-licence with a particular emphasis on fine wines. Applicants have assessed the local market and realised that there is potential due to the amount of office workers surrounding Bedford Place. Applicants intend to capitalise on the local market with a specific focus on top end clientele.

If 5,000 or more people are expected to attend the premises at any one time, please state the number expected to attend.

What licensable activities do you intend to carry on from the premises?

(Please see sections 1 and 14 of the Licensing Act 2003 and Schedules 1 and 2 to the Licensing Act 2003)

Provision of regulated entertainment

Please tick yes

- a) plays (if ticking yes, fill in box A)
- b) films (if ticking yes, fill in box B)
- c) indoor sporting events (if ticking yes, fill in box C)
- d) boxing or wrestling entertainment (if ticking yes, fill in box D)
- e) live music (if ticking yes, fill in box E)
- f) recorded music (if ticking yes, fill in box F)
- g) performances of dance (if ticking yes, fill in box G)
- h) anything of a similar description to that falling within (e), (f) or (g) (if ticking yes, fill in box H)

Provision of entertainment facilities:

- i) making music (if ticking yes, fill in box I)
- j) dancing (if ticking yes, fill in box J)
- k) entertainment of a similar description to that falling within (i) or (j) (if ticking yes, fill in box K)

Provision of late night refreshment (if ticking yes, fill in box L)

Supply of alcohol (if ticking yes, fill in box M)

In all cases complete boxes N, O and P

A

Plays Standard days and timings (please read guidance note 6)			Will the performance of a play take place indoors or outdoors or both – please tick (please read guidance note 2)	Indoors <input type="checkbox"/>
				Outdoors <input type="checkbox"/>
				Both <input type="checkbox"/>
Day	Start	Finish		
Mon			Please give further details here (please read guidance note 3)	
Tue				
Wed			State any seasonal variations for performing plays (please read guidance note 4)	
Thur				
Fri			Non standard timings. Where you intend to use the premises for the performance of plays at different times to those listed in the column on the left, please list (please read guidance note 5)	
Sat				
Sun				

B

Films Standard days and timings (please read guidance note 6)			Will the exhibition of films take place indoors or outdoors or both – please tick (please read guidance note 2)	Indoors	<input type="checkbox"/>
				Outdoors	<input type="checkbox"/>
				Both	<input type="checkbox"/>
Day	Start	Finish			
Mon			Please give further details here (please read guidance note 3)		
Tue					
Wed			State any seasonal variations for the exhibition of films (please read guidance note 4)		
Thur					
Fri			Non standard timings. Where you intend to use the premises for the exhibition of films at different times to those listed in the column on the left, please list (please read guidance note 5)		
Sat					
Sun					

C

Indoor sporting events Standard days and timings (please read guidance note 6)			<u>Please give further details</u> (please read guidance note 3)
Day	Start	Finish	
Mon			
Tue			<u>State any seasonal variations for indoor sporting events</u> (please read guidance note 4)
Wed			
Thur			<u>Non standard timings. Where you intend to use the premises for indoor sporting events at different times to those listed in the column on the left, please list</u> (please read guidance note 5)
Fri			
Sat			
Sun			

D

Boxing or wrestling entertainments Standard days and timings (please read guidance note 6)			<u>Will the boxing or wrestling entertainment take place indoors or outdoors or both – please tick</u> (please read guidance note 2)	Indoors	<input type="checkbox"/>
				Outdoors	<input type="checkbox"/>
				Both	<input type="checkbox"/>
Day	Start	Finish	<u>Please give further details here</u> (please read guidance note 3)		
Mon					
Tue					
Wed			<u>State any seasonal variations for boxing or wrestling entertainment</u> (please read guidance note 4)		
Thur					
Fri			<u>Non standard timings. Where you intend to use the premises for boxing or wrestling entertainment at different times to those listed in the column on the left, please list</u> (please read guidance note 5)		
Sat					
Sun					

E

Live music Standard days and timings (please read guidance note 6)			<u>Will the performance of live music take place indoors or outdoors or both – please tick</u> (please read guidance note 2)	Indoors	<input type="checkbox"/>
				Outdoors	<input type="checkbox"/>
				Both	<input type="checkbox"/>
Day	Start	Finish	<u>Please give further details here</u> (please read guidance note 3)		
Mon					
Tue					
Wed					
Thur					
			<u>State any seasonal variations for the performance of live music</u> (please read guidance note 4)		
Fri			<u>Non standard timings. Where you intend to use the premises for the performance of live music at different times to those listed in the column on the left, please list</u> (please read guidance note 5)		
Sat					
Sun					

F

Recorded music Standard days and timings (please read guidance note 6)			<u>Will the playing of recorded music take place indoors or outdoors or both – please tick</u> (please read guidance note 2)	Indoors	<input type="checkbox"/>
				Outdoors	<input type="checkbox"/>
				Both	<input type="checkbox"/>
Day	Start	Finish	<u>Please give further details here</u> (please read guidance note 3)		
Mon					
Tue					
Wed			<u>State any seasonal variations for the playing of recorded music</u> (please read guidance note 4)		
Thur					
Fri			<u>Non standard timings. Where you intend to use the premises for the playing of recorded music at different times to those listed in the column on the left, please list</u> (please read guidance note 5)		
Sat					
Sun					

G

Performances of dance Standard days and timings (please read guidance note 6)			<u>Will the performance of dance take place indoors or outdoors or both – please tick</u> (please read guidance note 2)	Indoors	<input type="checkbox"/>
				Outdoors	<input type="checkbox"/>
				Both	<input type="checkbox"/>
Day	Start	Finish	<u>Please give further details here</u> (please read guidance note 3)		
Mon					
Tue			<u>State any seasonal variations for the performance of dance</u> (please read guidance note 4)		
Wed					
Thur			<u>Non standard timings. Where you intend to use the premises for the performance of dance at different times to those listed in the column on the left, please list</u> (please read guidance note 5)		
Fri					
Sat					
Sun					

H

Anything of a similar description to that falling within (e), (f) or (g) Standard days and timings (please read guidance note 6)			<u>Please give a description of the type of entertainment you will be providing</u>		
Day	Start	Finish	<u>Will this entertainment take place indoors or outdoors or both – please tick</u> (please read guidance note 2)	Indoors	<input type="checkbox"/>
Mon				Outdoors	<input type="checkbox"/>
				Both	<input type="checkbox"/>
Tue			<u>Please give further details here</u> (please read guidance note 3)		
Wed					
Thur			<u>State any seasonal variations for entertainment of a similar description to that falling within (e), (f) or (g)</u> (please read guidance note 4)		
Fri					
Sat			<u>Non standard timings. Where you intend to use the premises for the entertainment of a similar description to that falling within (e), (f) or (g) at different times to those listed in the column on the left, please list</u> (please read guidance note 5)		
Sun					

I

Provision of facilities for making music Standard days and timings (please read guidance note 6)			<u>Please give a description of the facilities for making music you will be providing</u>	
			<u>Will the facilities for making music be indoors or outdoors or both – please tick</u> (please read guidance note 2)	
Day	Start	Finish		
Mon			<u>Please give further details here</u> (please read guidance note 3)	
Tue				
Wed			<u>State any seasonal variations for the provision of facilities for making music</u> (please read guidance note 4)	
Thur				
Fri			<u>Non standard timings. Where you intend to use the premises for provision of facilities for making music at different times to those listed in the column on the left, please list</u> (please read guidance note 5)	
Sat				
Sun				

J

Provision of facilities for dancing Standard days and timings (please read guidance note 6)			<u>Will the facilities for dancing be indoors or outdoors or both – please tick</u> (see guidance note 2)	Indoors <input type="checkbox"/>	
				Outdoors <input type="checkbox"/>	
				Both <input type="checkbox"/>	
			<u>Please give a description of the facilities for dancing you will be providing</u>		
Day	Start	Finish			
Mon			<u>Please give further details here</u> (please read guidance note 3)		
Tue					
Wed					
Thur			<u>State any seasonal variations for providing dancing facilities</u> (please read guidance note 4)		
Fri			<u>Non standard timings. Where you intend to use the premises for the provision of facilities for dancing entertainment at different times to those listed in the column on the left, please list</u> (please read guidance note 5)		
Sat					
Sun					

K

Provision of facilities for entertainment of a similar description to that falling within i or j Standard days and timings (please read guidance note 6)			<u>Please give a description of the type of entertainment facility you will be providing</u>		
Day	Start	Finish	<u>Will the entertainment facility be indoors or outdoors or both – please tick</u> (please read guidance note 2)	Indoors	<input type="checkbox"/>
Mon				Outdoors	<input type="checkbox"/>
				Both	<input type="checkbox"/>
Tue			<u>Please give further details here</u> (please read guidance note 3)		
Wed					
Thur			<u>State any seasonal variations for the provision of facilities for entertainment of a similar description to that falling within i or j</u> (please read guidance note 4)		
Fri					
Sat			<u>Non standard timings. Where you intend to use the premises for the provision of facilities for entertainment of a similar description to that falling within i or j at different times to those listed in the column on the left, please list</u> (please read guidance note 5)		
Sun					

L

Late night refreshment Standard days and timings (please read guidance note 6)			Will the provision of late night refreshment take place indoors or outdoors or both – please tick (please read guidance note 2)	Indoors	<input type="checkbox"/>
				Outdoors	<input type="checkbox"/>
				Both	<input type="checkbox"/>
Day	Start	Finish			
Mon			<u>Please give further details here</u> (please read guidance note 3)		
Tue					
Wed			<u>State any seasonal variations for the provision of late night refreshment</u> (please read guidance note 4)		
Thur					
Fri			<u>Non standard timings. Where you intend to use the premises for the provision of late night refreshment at different times, to those listed in the column on the left, please list</u> (please read guidance note 5)		
Sat					
Sun					

M

Supply of alcohol Standard days and timings (please read guidance note 6)			Will the supply of alcohol be for consumption (Please tick box) (please read guidance note 7)	On the premises	<input type="checkbox"/>
				Off the premises	<input checked="" type="checkbox"/>
				Both	<input type="checkbox"/>
Day	Start	Finish	State any seasonal variations for the supply of alcohol (please read guidance note 4) None		
Mon	09:00	23:00			
Tue	09:00	23:00			
Wed	09:00	23:00			
Thur	09:00	23:00			
Fri	09:00	23:00			
Sat	09:00	23:00			
Sun	09:00	23:00			
			Non standard timings. Where you intend to use the premises for the supply of alcohol at different times to those listed in the column on the left, please list (please read guidance note 5)		

State the name and details of the individual whom you wish to specify on the licence as premises supervisor

Address	
Postcode	

N

Please highlight any adult entertainment or services, activities, other entertainment or matters ancillary to the use of the premises that may give rise to concern in respect of children (please read guidance note 8)

Sale of alcohol

O

Hours premises are open to the public Standard days and timings (please read guidance note 6)			State any seasonal variations (please read guidance note 4) None
Day	Start	Finish	Non standard timings. Where you intend the premises to be open to the public at different times from those listed in the column on the left, please list (please read guidance note 5)
Mon	09:00	23:00	
Tue	09:00	23:00	
Wed	09:00	23:00	
Thur	09:00	23:00	
Fri	09:00	23:00	
Sat	09:00	23:00	
Sun	09:00	23:00	

P Describe the steps you intend to take to promote the four licensing objectives:

a) General – all four licensing objectives (b,c,d,e) (please read guidance note 9)

Please see attached sheet.

b) The prevention of crime and disorder

Please see attached sheet.

c) Public safety

Please see attached sheet.

d) The prevention of public nuisance

Please see attached sheet.

e) The protection of children from harm

Please see attached sheet.

Steps to be taken to meet the four Licensing Objectives

a) General

Applicants will ensure that the premises are responsibly managed and supervised at all times to ensure that the appropriate steps are taken to promote the four Licensing Objectives.

b) Prevention of Crime and Disorder

The CCTV system will be installed and maintained in the Licensed Premises to the satisfaction of the Licensing Authority, Hampshire Constabulary and Trading Standards. As a minimum, it will enable surveillance of both external and internal areas of the premises including entrances and exits. Recordings from the system will be of a quality acceptable as evidence in a Court of Law and will be securely retained at the premises for a minimum period of 30 days after the recording and will be surrendered to Hampshire Constabulary Licensing Authority or Trading Standards immediately on request. The Premises Licenceholder and staff will be capable of operating the CCTV system.

The Premises Licenceholder will keep complete records, such as invoices, receipts and delivery notes, relating to alcohol and cigarettes obtained by him for sale in the premises. Records will include the name, address and telephone number of the supplier, the date of supply, the product supplied and the prices. Where items have been delivered to the premises from a vehicle, details of the vehicle registration, the name of the delivery person and contact details including the name, address and telephone number for the business will be kept. These details will be available on request to responsible authorities within 24 hours.

The applicant will ensure that every individual who appears to be under 25 years of age seeking to purchase or be supplied with alcohol at or from the premises shall produce means of identification acceptable to the Licensing Authority proving that individual to be 18 years of age or older. If the person seeking alcohol is unable to produce acceptable means of identification, no sale or supply of alcohol will be made to or for that person. Notices regarding the store's 'Challenge 25' policy will be displayed.

All staff who sell alcohol will be trained to NCPLH level. All sales of alcohol must be directly supervised and authorised by a Personal Licenceholder until such staff have achieved training to NCPLH level.

That staff are trained regarding appropriate precautions to prevent the sale of alcohol to persons under the age of 18, that records are kept of such training, which are signed and dated by the member of staff who has received the training, that staff receiving refresher training every six months as a minimum and that records signed and dated by the member of staff, are kept of this refresher training. Records of training will be available for inspection by Hampshire Constabulary, the Licensing Authority, Trading Standards and other responsible authorities on request.

The holder of the Premises Licence will keep a written record, namely a refusals book, of those instances where a person who a member of staff believes to be under the age of 18, and is unable to produce acceptable means of identification proving that they are of 18 years or more, attempts to purchase alcohol and is refused. The records will include details, in English, of the date, time, a brief description including estimated age, of the person who attempted to purchase the alcohol, the type of alcohol and the name of the person who refused the sale. Staff will be trained in the

use of the refusals book and it will be kept in a readily accessible place known by all members of staff. The record will be regularly checked by the Premises Licenceholder or the Designated Premises Supervisor to ensure that all staff are completing records and this person will sign and date the record as evidence that they have checked it. The refusals book will be available for inspection by all relevant authorities on request.

c) Public Safety

A fire protection and warning system will be in place along with fire extinguishers and an emergency lighting system will be in place.

d) Prevention of Public Nuisance

Deliveries will be conducted during the daytime to control noise nuisance.

e) Protection of Children from Harm

1. We will adopt the 'Challenge 25' scheme (see above).
2. All staff will be trained to NCPLH level (see above).

Please tick yes

- I have made or enclosed payment of the fee
- I have enclosed the plan of the premises
- I have sent copies of this application and the plan to responsible authorities and others where applicable
- I have enclosed the consent form completed by the individual I wish to be premises supervisor, if applicable
- I understand that I must now advertise my application
- I understand that if I do not comply with the above requirements my application will be rejected

IT IS AN OFFENCE, LIABLE ON CONVICTION TO A FINE UP TO LEVEL 5 ON THE STANDARD SCALE, UNDER SECTION 158 OF THE LICENSING ACT 2003 TO MAKE A FALSE STATEMENT IN OR IN CONNECTION WITH THIS APPLICATION

Part 4 – Signatures (please read guidance note 10)

Signature of applicant or applicant’s solicitor or other duly authorised agent (See guidance note 11). **If signing on behalf of the applicant please state in what capacity.**

Signature	
Date	9 December 2010
Capacity	Solicitor

For joint applications signature of 2nd applicant or 2nd applicant’s solicitor or other authorised agent. (please read guidance note 12). **If signing on behalf of the applicant please state in what capacity.**

Signature	
Date	
Capacity	

Contact name (where not previously given) and postal address for correspondence associated with this application (please read guidance note 13)

Mr David Lee
Eric Robinson Solicitors
4 Carlton Crescent

DX 38546 Southampton 3

Post town | Southampton

Post code | SO15 2EY

Telephone number (if any) |

If you would prefer us to correspond with you by e-mail your e-mail address (optional)

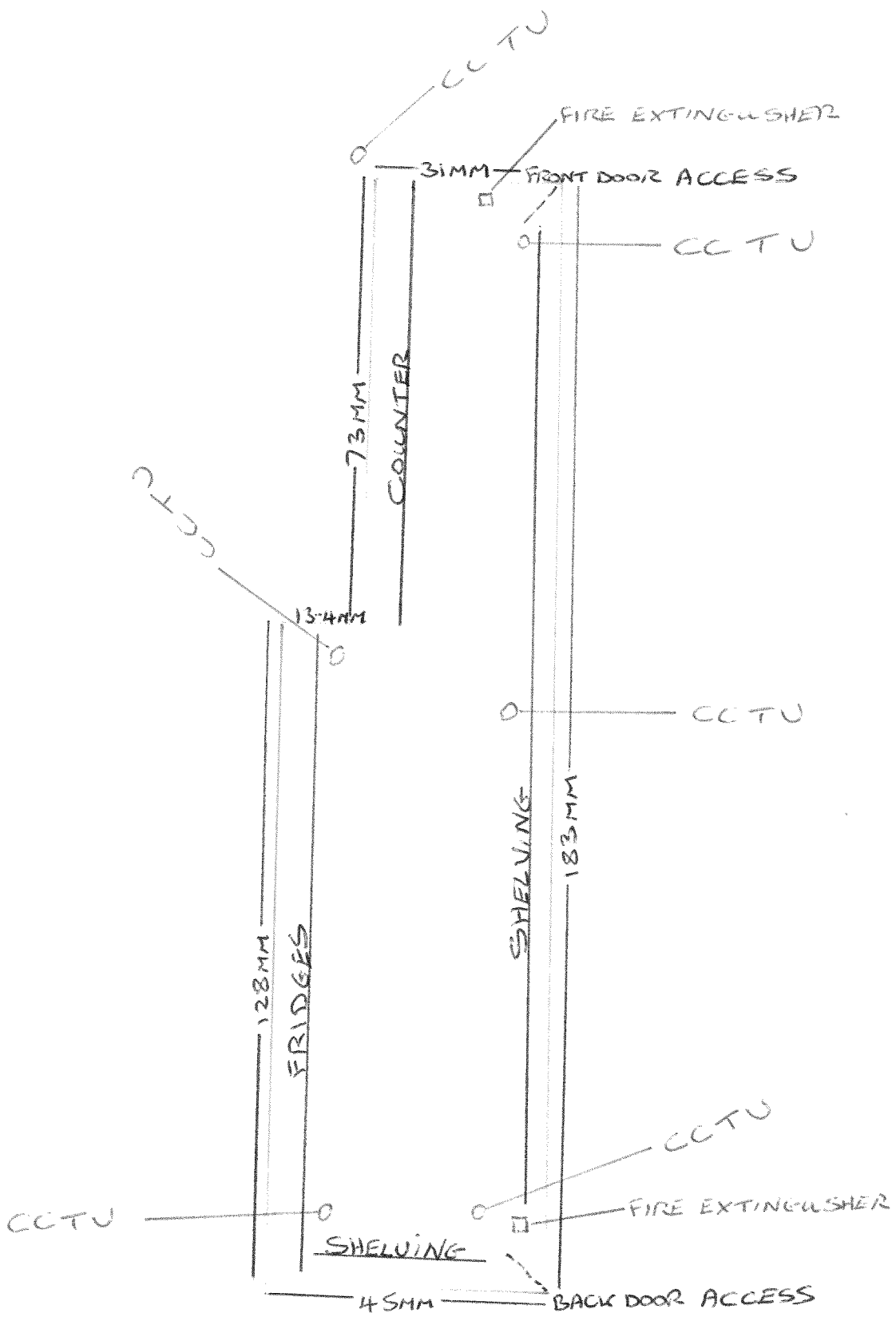

1:100 SCALE

From: Licensing
Sent: 17 December 2010 19:26
To: Licensing
Subject: PublicAccess for Licensing - Application Comments
(2010/02434/01SPRN)

Dr J.Krir has used the PublicAccess website to submit their comments on a Licensing Application. You have received this message because you are the Case Officer for this application or because this is a designated mailbox for PublicAccess comments submissions.

Comments were submitted at 17/12/2010 19:25:32.

Application Summary

Application Number:
2010/02434/01SPRN

Address:
69 Bedford Place
Southampton
Hampshire
SO15 2DS

Customer Details

Name:
Dr J.Krir

Address:
76 Bedford Place
Southampton
SO15 2DF

Representation Type:
Trader

Objection Type:
Licensing Objectives

Comments:

Have you any idea how many glasses, empty cans, rubbish, take away cartons, sick, faeces etc that appear every week in the car park of our premises - all fuelled by alcohol I am sure - I object strongly to yet another alcohol outlet in Bedford Place. The general public are well served already by outlets selling alcohol in Bedford Place - Champagne Charlies, Cloud 9, Sainsbury's, Co-op, McCalls - how can we possibly need another one?? PLEASE do not allow this to go ahead.

From: Licensing
Sent: 18 December 2010 10:10
To: Licensing
Subject: PublicAccess for Licensing - Application Comments
(2010/02434/01SPRN)

Sam Lowe has used the PublicAccess website to submit their comments on a Licensing Application. You have received this message because you are the Case Officer for this application or because this is a designated mailbox for PublicAccess comments submissions.

Comments were submitted at 18/12/2010 10:09:59

Application Summary

Application Number:
2010/02434/01SPRN

Address:
69 Bedford Place
Southampton
Hampshire
SO15 2DS

Customer Details

Name:
Sam Lowe

Address:
Phase 3 Southampton
37 Bedford Place
Southampton
SO15 2DG

Representation Type:
Trader

Objection Type:
Licensing Objectives

Comments:

There is no need for further licensed premises on Bedford Place, there is already enough littering and unruly behaviour caused by the proliferation of cheap alcohol being sold until late hours.

The addition of another Off License will surely drive prices down within the new establishment, and potentially the rest also, as competition between outlets increases and the ability to draw custom becomes harder (the population is not increasing), this goes against current Government plans to curb the sale of cheaper and cheaper alcohol and combat binge drinking - a problem already recognised within Southampton City Council hence the standing Cumulative Impact Assessment policy for licensed premises in the surrounding area.

From: Licensing
Sent: 19 December 2010 16:12
To: Licensing
Subject: PublicAccess for Licensing - Application Comments
(2010/02434/01SPRN)

Karen Holloway has used the PublicAccess website to submit their comments on a Licensing Application. You have received this message because you are the Case Officer for this application or because this is a designated mailbox for PublicAccess comments submissions.

Comments were submitted at 19/12/2010 16:11:59.

Application Summary

Application Number:
2010/02434/01SPRN

Address:
69 Bedford Place
Southampton
Hampshire
SO15 2DS

Customer Details

Name:
Karen Holloway

Address:
Esthetix Face & Body Care
31 Carlton Place
Southampton
SO15 2DX

Comments

Representation Type:
Local Trader Group
Objection Type:
Licensing Objectives
Comments:

As a trader in the Bedford Place area, I strongly object to yet another off licence opening. We suffer daily the effects of drink induced nuisance, which includes, vomit, urine, defaecation, endless bottles and rubbish, alot of which end up in our doorway. There are already plenty of outlets selling alcohol and I really don't think we need another one especially as the Government are trying to clamp down on the sales of alcohol. We are open until late in the evening as are most other businesses and it can be frightening for both my customers and myself leaving my premises as even at 7pm at night there are allready drunks around. We need to re-establish Bedford Place as an up market area for shoppers and people needing hair and beauty treatments. The police and counsel have already put forward the proposal to close Carlton Place to traffic, which would cause major disruption to businesses, as they were concerned about the drunken crowds in the evening. This must mean that they are already concerned about the problem.

From: Licensing
Sent: 19 December 2010 18:43
To: Licensing
Subject: PublicAccess for Licensing - Application Comments
(2010/02434/01SPRN)

Gerry Heeley has used the PublicAccess website to submit their comments on a Licensing Application. You have received this message because you are the Case Officer for this application or because this is a designated mailbox for PublicAccess comments submissions.

Comments were submitted at 19/12/2010 18:42:46.

Application Summary

Application Number:
2010/02434/01SPRN

Address:
69 Bedford Place
Southampton
Hampshire
SO15 2DS

Customer Details

Name:
Gerry Heeley

Address:
Phase 3 HiFi
37 Bedford Place
Southampton
SO15 2DG

Comments

Representation Type:
Trader

Objection Type:
Licensing Objectives

Comments:

I strongly object to this application on the following grounds:

- 1) There are currently SIX business selling alcohol off license in the immediate area. What useful purpose can another one serve?
- 2) The issue of public nuisance is becoming much worse in Bedford place and the sale of yet more alcohol can ONLY increase this. My business premise is regularly subjected to criminal damage and general nuisance at night. Rubbish, litter and vomit. There are vagrants sleeping in shop doorways and little or no police support. WHY ON EARTH DO WE NEED MORE ALCOHOL BEING SOLD

From: Licensing
Sent: 07 January 2011 10:53
To: Licensing
Subject: PublicAccess for Licensing - Application Comments
(2010/02434/01SPRN)

PublicAccess for Licensing - Application Comments (2010/02434/01SPRN)

Simon Beer has used the PublicAccess website to submit their comments on a Licensing Application. You have received this message because you are the Case Officer for this application or because this is a designated mailbox for PublicAccess comments submissions.

Comments were submitted at 07/01/2011 10:53:22

Application Summary

Application Number:
2010/02434/01SPRN

Address:
69 Bedford Place
Southampton
Hampshire
SO15 2DS

Customer Details

Name:
Simon Beer

Address:
Bridge Gallery
32 Bedford Place
Southampton
SO15 2DG

Comments

Representation Type:
Trader

Comments:

I am objecting to the application at 69 Bedford Place on the grounds that with already six premises selling alcohol yet another WILL start a price war to obtain dormancy in a market off no more than 200 meters from the first premises to last.

1. With a number of schools in the finicality namely St Anne's, promotion of cheep alcohol to influential minds is something I'm sure Southampton City Council will find hard to defend.
2. As witnessed by myself cheep alcohol is being purchased before nights out, people are turning up to bars already under the influence and putting pressure on door staff, causing public nuisance and disorder.
3. I have been in Bedford Place at 2am on any given Tuesday night (student night) because of an attempted brake inn and witnessed more public disorder than I have seen in a lifetime- vomiting, urinating and fighting. Police were under staffed and public safety was an issue. This was a direct result of too many premises again selling cheep alcohol.

From: Licensing
Sent: 07 January 2011 13:26
To: Licensing
Subject: PublicAccess for Licensing - Application Comments
(2010/02434/01SPRN)

PublicAccess for Licensing - Application Comments (2010/02434/01SPRN)

Susan Ridley t/a Banister Guest House has used the PublicAccess website to submit their comments on a Licensing Application. You have received this message because you are the Case Officer for this application or because this is a designated mailbox for PublicAccess comments submissions.

Comments were submitted at 07/01/2011 13:26:04

Application Summary

Application Number:
2010/02434/01SPRN

Address:
69 Bedford Place
Southampton
Hampshire
SO15 2DS

Customer Details

Name:
Susan Ridley t/a Banister Guest House

Address:
11 Brighton Road
Southampton
so15 2jj

Comments

Representation Type:
Trader

Comments:

We feel that it unnecessary to grant a licence to yet another place selling alcohol in the street, there are already six premises. We suffer daily with beggars who sit around front doors, then in the evenings hoards of drunken young people who leave a trail of devastation in their wake. Please, please don't grant a licence to anyone else who can sell alcohol.

From: Licensing
Sent: 07 January 2011 13:48
To: Licensing
Subject: PublicAccess for Licensing - Application Comments
(2010/02434/01SPRN)

PublicAccess for Licensing - Application Comments (2010/02434/01SPRN)

Peter M Nugent has used the PublicAccess website to submit their comments on a Licensing Application. You have received this message because you are the Case Officer for this application or because this is a designated mailbox for PublicAccess comments submissions.

Comments were submitted at 07/01/2011 13:47:38

Application Summary

Application Number:
2010/02434/01SPRN

Address:
69 Bedford Place
Southampton
Hampshire
SO15 2DS

Customer Details

Name:
Peter M Nugent

Address:
Atlantic Dry Cleaners & Tailors
49/50 Bedford Place
Southampton
Hampshire
SO15 2DG

Comments

Representation Type:
Trader

Objection Type:
Licensing Objectives

Comments:

I am writing to object to this application and the prospect of yet another alcohol retailer in the street. We already have a lot of problem with disorderly behaviour in the street. We are regularly replacing our signs, clearing up mess (our porch is being used as a urinal) and erasing graffiti.
I hope that you take this seriously as I am not alone in feeling this way.
Many thanks

From: Licensing
Sent: 07 January 2011 14:29
To: Licensing
Subject: PublicAccess for Licensing - Application Comments
(2010/02434/01SPRN)

PublicAccess for Licensing - Application Comments (2010/02434/01SPRN)

Stuart Conway has used the PublicAccess website to submit their comments on a Licensing Application. You have received this message because you are the Case Officer for this application or because this is a designated mailbox for PublicAccess comments submissions.

Comments were submitted at 07/01/2011 14:29:04

Application Summary

Application Number:
2010/02434/01SPRN

Address:
69 Bedford Place
Southampton
Hampshire
SO15 2DS

Customer Details

Name:
Stuart Conway

Address:
Electric Bike World
54 Bedford Place
Southampton
SO15 2DT

Representation Type:
Trader

Objection Type:
Licensing Objectives

Comments:
I am against another off licence being opeded in Bedford Place.

There are 5 off licences in this road, all within 100 yards of each other. That is already too many for the needs of the area. No one is going thirsty and the prices are already too low which causes a lot of alcohol related problems on a daily basis.

Another off licence will only sell the same products and so will have to compete on price in order to pinch their trade. The existing outlets will have to retaliate, which is the last thing this area needs, and is very much against against current government thinking.

If the councils only wish is to get the shop open so that they can start paying council tax, this is the wrong way to acheive this, because its likely that one of the other shops will close as there is not enough trade for 6 off licences which all nearly next door to each other.

Almost every morning there is rubbish empty broken glass bottles and discarded beer and cider cans strewn oll over the place that we have to clear up along with and peoples sick to clear up. It really discusting.

There is not a single good reason for having a 6th off licence in this road.

Please dont allow it.

From: Licensing
Sent: 07 January 2011 15:03
To: Licensing
Subject: PublicAccess for Licensing - Application Comments
(2010/02434/01SPRN)

PublicAccess for Licensing - Application Comments (2010/02434/01SPRN)

marie-claire prettyman has used the PublicAccess website to submit their comments on a Licensing Application. You have received this message because you are the Case Officer for this application or because this is a designated mailbox for PublicAccess comments submissions.

Comments were submitted at 07/01/2011 15:03:09

Application Summary

Application Number:
2010/02434/01SPRN

Address:
69 Bedford Place
Southampton
Hampshire
SO15 2DS

Customer Details

Name:
marie-claire prettyman

Address:
81 bedford place
Lower ground floor
Bedford place
so15 2df

Comments

Objection Type:
Licensing Objectives

Comments:

I'm sure that it is not news to the council that bedford place has seriously lost its identity over the last few years, from a place for independent traders offering unique services and retail-to a night venue which draws the students and party goers most nights. As someone who spends nearly every day clearing up the effects of drunken behaviour I am against bringing another shop selling booze to the area-it lowers the tone and encourages drunkenness. We already have a very nice wine shop and cheaper venues for booze we do not need another!

From: Licensing
Sent: 07 January 2011 15:25
To: Licensing
Subject: PublicAccess for Licensing - Application Comments
(2010/02434/01SPRN)

PublicAccess for Licensing - Application Comments (2010/02434/01SPRN)

cllr Damani has used the PublicAccess website to submit their comments on a Licensing Application. You have received this message because you are the Case Officer for this application or because this is a designated mailbox for PublicAccess comments submissions.

Comments were submitted at 07/01/2011 15:25:17

Application Summary

Application Number:
2010/02434/01SPRN

Address:
69 Bedford Place
Southampton
Hampshire
SO15 2DS

Customer Details

Name:
cllr Damani

Address:
Civic Centre
southampton
SO14 7LY

Comments

Representation Type:
Ward Councillor

Objection Type:
Licensing Objectives

Comments:

i am very concerned that there are already many issues that residents in the area are concerned with regarding alcohol use. there are many licenced premises in the area, both Bedford Place nad London Road and i don't think we need more of these, this already creates drunkenness and anti-social behavior and rowdiness where residents are constantly woken up from their sleep. this public nuisance is a matter of distress to many residents who are at the sharp end of this.drunken behaviour poses danger to the public and passers-by and the screaming and shouting is of real upset to the residents, affecting their health and genral well being. i object to this premises being licensed for all the above reasons and particulary when we are also concerned nationally about alcohol and the effects on neighbourhoods, plus the ill health and crimes and anti-social behaviours it causes

From: Licensing
Sent: 08 January 2011 14:43
To: Licensing
Subject: PublicAccess for Licensing - Application Comments
(2010/02434/01SPRN)

PublicAccess for Licensing - Application Comments (2010/02434/01SPRN)

sue conchie has used the PublicAccess website to submit their comments on a Licensing Application. Comments were submitted at 08/01/2011 14:42:57

Application Summary

Application Number:
2010/02434/01SPRN

Address:
69 Bedford Place
Southampton
Hampshire
SO15 2DS

Name:
sue conchie

Address:
Banister House,
11 Brighton Road,
Southampton
SO15 2JJ

Comments

I am extremely alarmed at the possibility of yet another Premises in Bedford Place selling Alcohol. The government talk about the ill effects of alcohol on the young and here we are with 7 outlets offering cheap alcohol and another being considered. It does not make sense.

The top end of Bedford Place is an area which has attracted many valuable independent businesses, at high rent and rates, with no support from the council. We have to put up with beggars during the day and rowdy young people at night dropping litter and bottles all over the place. Some of the shops offer upmarket goods, which attract good clientele, but these people will desert the area if it continues to go downhill. More imagination should be used in filling empty units.

If this new offlicence goes ahead, it will impact badly on the existing ones, especially those that are independent and not part of a large group.

I hope commonsense will prevail.